

P-Channel Enhancement Mode Field Effect Transistor

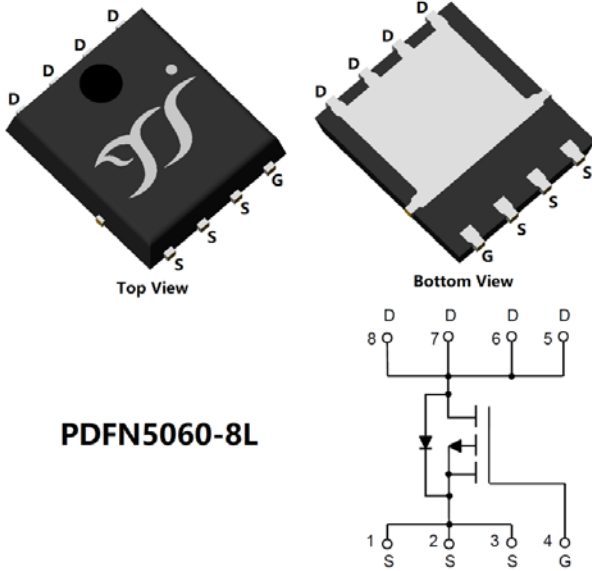

PDFN5060-8L

Product Summary

- V_{DS} -100 V
- I_D -17 A
- $R_{DS(ON)}$ (at $V_{GS}=-10V$) <122m Ω
- 100% EAS Tested
- 100% ∇V_{DS} Tested

General Description

- Low $R_{DS(on)}$ & FOM
- Excellent stability and uniformity
- Moisture Sensitivity Level 1
- Epoxy Meets UL 94 V-0 Flammability Rating
- Halogen Free
- Part no. with suffix "Q" means AEC-Q101 qualified

Applications

- Power management
- Portable equipment
- 12V Automotive systems

■ Absolute Maximum Ratings ($T_A=25^\circ C$ unless otherwise noted)

| Parameter | | Symbol | Limit | Unit |
|--|-------------------|----------------|----------|------------|
| Drain-source Voltage | | V_{DS} | -100 | V |
| Gate-source Voltage | | V_{GS} | ± 20 | V |
| Drain Current | $T_A=25^\circ C$ | I_D | -3 | A |
| | $T_A=100^\circ C$ | | -1.9 | |
| | $T_C=25^\circ C$ | | -17 | |
| | $T_C=100^\circ C$ | | -11 | |
| Pulsed Drain Current ^A | | I_{DM} | -36 | A |
| Avalanche energy ^B | | EAS | 64 | mJ |
| Total Power Dissipation ^C | $T_A=25^\circ C$ | P_D | 2.1 | W |
| | $T_A=100^\circ C$ | | 0.8 | |
| | $T_C=25^\circ C$ | | 69 | |
| | $T_C=100^\circ C$ | | 27 | |
| Junction and Storage Temperature Range | | T_J, T_{STG} | -55~+150 | $^\circ C$ |

■ Thermal resistance

| Parameter | | Symbol | Typ | Max | Units |
|---|--------------|-----------------|-----|-----|--------------|
| Thermal Resistance Junction-to-Ambient ^D | Steady-State | $R_{\theta JA}$ | 48 | 58 | $^\circ C/W$ |
| Thermal Resistance Junction-to-Case | Steady-State | $R_{\theta JC}$ | 1.5 | 1.8 | |



YJG122GP10HHQ

■ Ordering Information (Example)

| PREFERRED P/N | PACKING CODE | Marking | MINIMUM PACKAGE(pcs) | INNER BOX QUANTITY(pcs) | OUTER CARTON QUANTITY(pcs) | DELIVERY MODE |
|---------------|--------------|-------------|----------------------|-------------------------|----------------------------|---------------|
| YJG122GP10HHQ | F1 | YJG122GP10H | 5000 | 10000 | 100000 | 13" reel |

■ Electrical Characteristics (T_J=25°C unless otherwise noted)

| Parameter | Symbol | Conditions | Min | Typ | Max | Units |
|---------------------------------------|---------------------|---|------|-------|------|-------|
| Static Parameter | | | | | | |
| Drain-Source Breakdown Voltage | BV _{DSS} | V _{GS} = 0V, I _D =-250μA | -100 | - | - | V |
| Zero Gate Voltage Drain Current | I _{DSS} | V _{DS} =-100V, V _{GS} =0V | - | - | -1 | μA |
| Gate-Body Leakage Current | I _{GSS} | V _{GS} = ±20V, V _{DS} =0V | - | - | ±100 | nA |
| Gate Threshold Voltage | V _{GS(th)} | V _{DS} = V _{GS} , I _D =-250μA | -2 | -2.6 | -3.5 | V |
| Static Drain-Source On-Resistance | R _{DS(on)} | V _{GS} =-10V, I _D =-15A | - | 94 | 122 | mΩ |
| Diode Forward Voltage | V _{SD} | I _S =-10A, V _{GS} =0V | - | -0.87 | -1.2 | V |
| Gate resistance | R _G | f=1MHz | - | 12 | - | Ω |
| Maximum Body-Diode Continuous Current | I _S | | - | - | -15 | A |
| Dynamic Parameters | | | | | | |
| Input Capacitance | C _{iss} | V _{DS} =-25V, V _{GS} =0V, f=1MHz | - | 900 | - | pF |
| Output Capacitance | C _{oss} | | - | 140 | - | |
| Reverse Transfer Capacitance | C _{rss} | | - | 6.2 | - | |
| Switching Parameters | | | | | | |
| Total Gate Charge | Q _g | V _{GS} =-10V, V _{DS} =-50V, I _D =-7.5A | - | 15.4 | - | nC |
| Gate-Source Charge | Q _{gs} | | - | 5.3 | - | |
| Gate-Drain Charge | Q _{gd} | | - | 2.9 | - | |
| Reverse Recovery Charge | Q _{rr} | I _F =-7.5A, di/dt=100A/us | - | 95 | - | nC |
| Reverse Recovery Time | t _{rr} | | - | 57 | - | ns |
| Turn-on Delay Time | t _{D(on)} | V _{GS} =-10V, V _{DS} =-50V, I _D =-7.5A | - | 9.8 | - | ns |
| Turn-on Rise Time | t _r | | - | 35 | - | |
| Turn-off Delay Time | t _{D(off)} | | - | 34.8 | - | |
| Turn-off fall Time | t _f | | - | 46 | - | |

A. Repetitive rating; pulse width limited by max. junction temperature.

B. T_J=25°C, V_{DD}=-50V, V_{GS}=-10V, L=0.5mH, I_{AS}=-16A.

C. P_d is based on max. junction temperature, using junction-case and junction-ambient thermal resistance.

D. The value of R_{θJA} is measured with the device mounted on the minimum recommend pad size, in the still air environment with T_A=25°C. The maximum allowed junction temperature of 150°C. The value in any given application depends on the user's specific board design.



YJG122GP10HHQ

Typical Electrical and Thermal Characteristics Diagrams

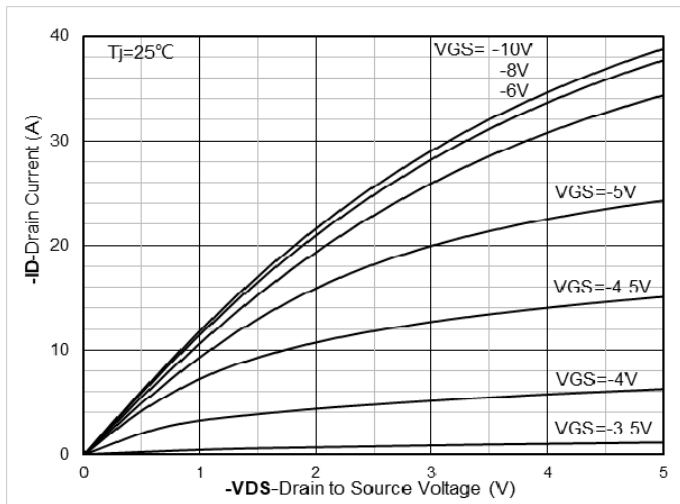

Figure 1. Output Characteristics

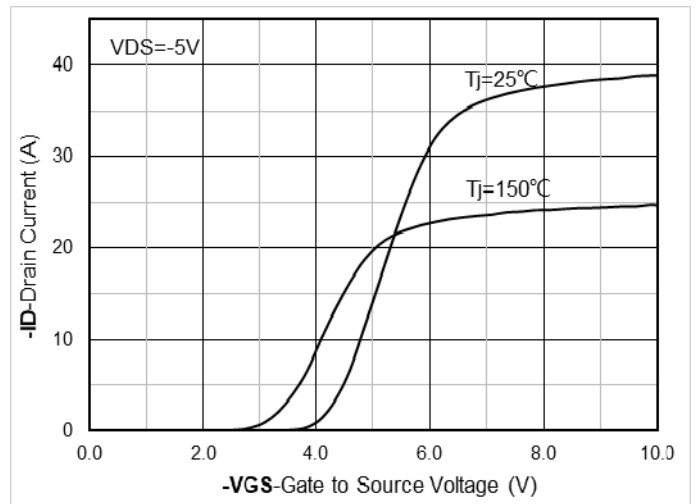

Figure 2. Transfer Characteristics

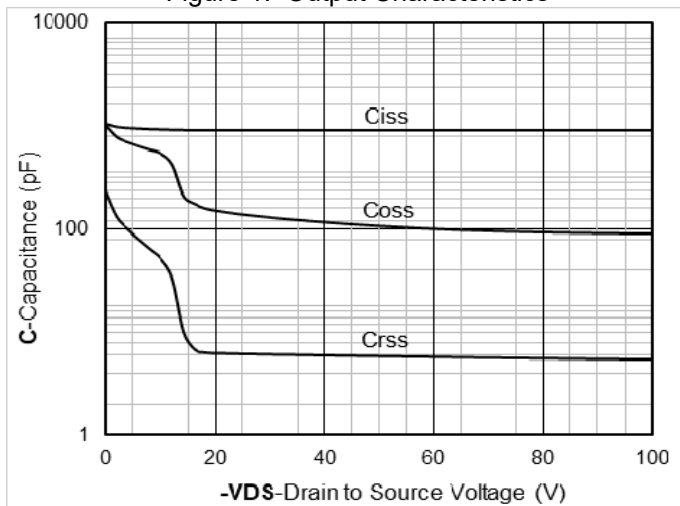

Figure 3. Capacitance Characteristics

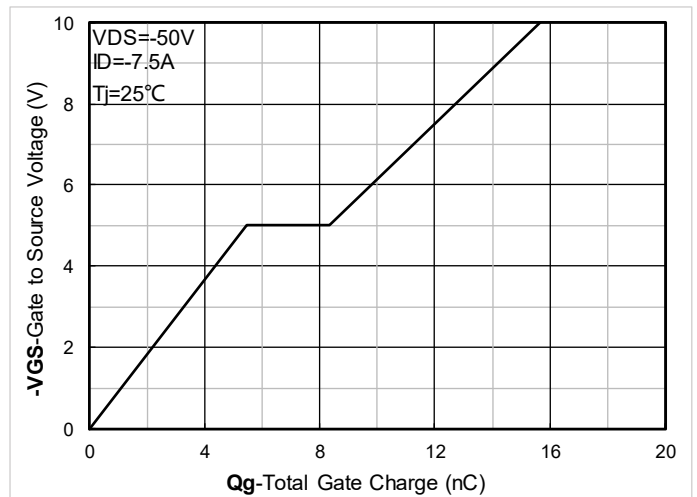

Figure 4. Gate Charge

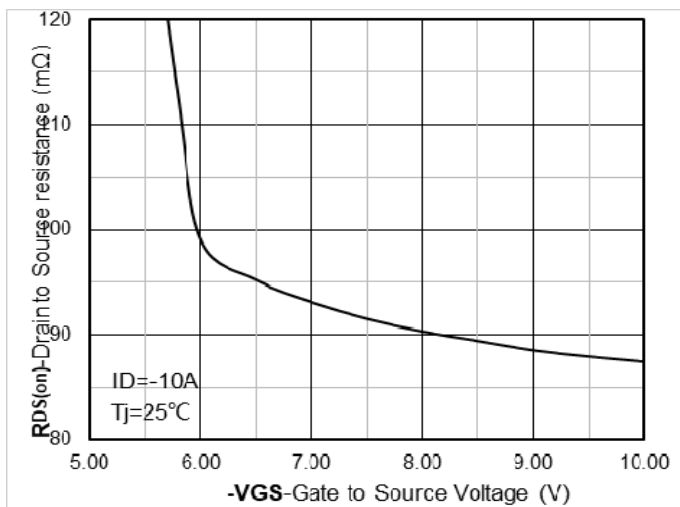

Figure 5. On-Resistance vs Gate to Source Voltage

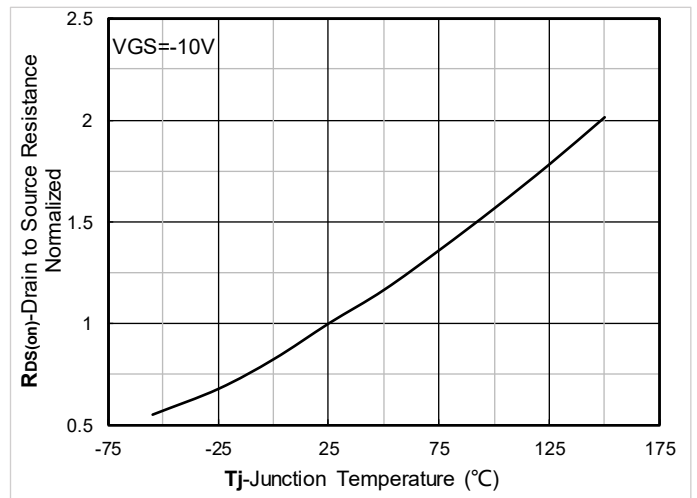

Figure 6. Normalized On-Resistance



YJG122GP10HHQ

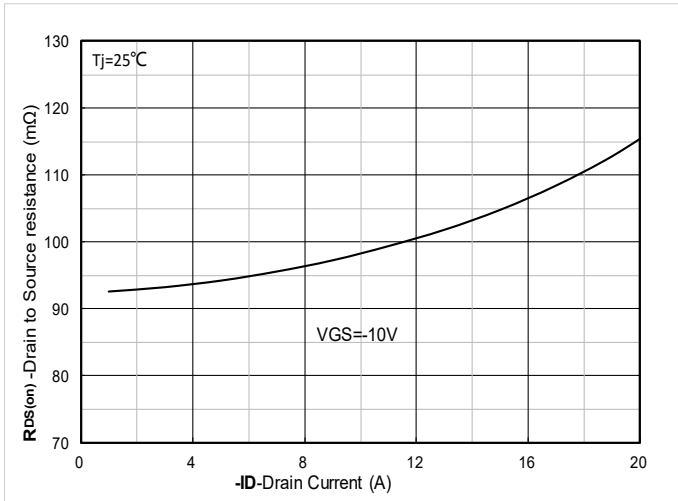

Figure 7. RDS(on) VS Drain Current

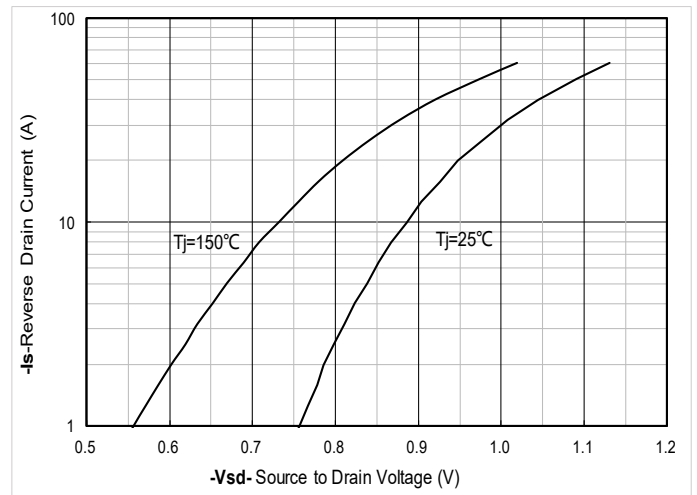

Figure 8. Forward characteristics of reverse diode

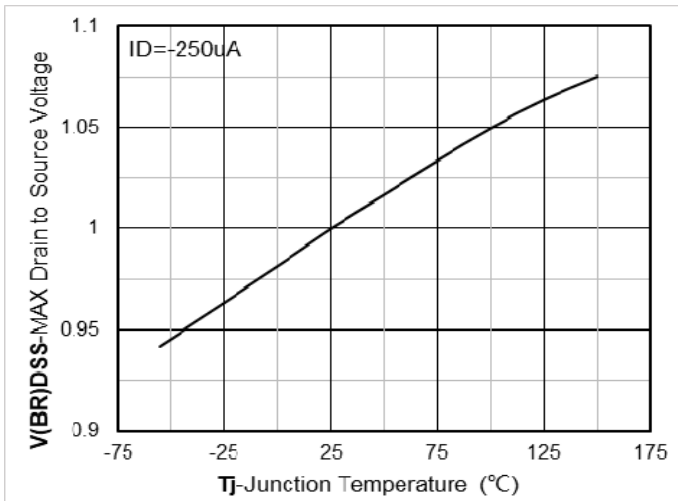

Figure 9. Normalized breakdown voltage

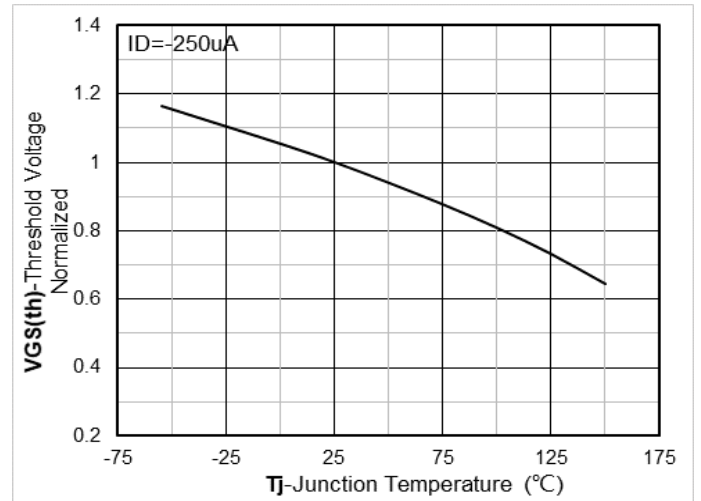

Figure 10. Normalized Threshold voltage

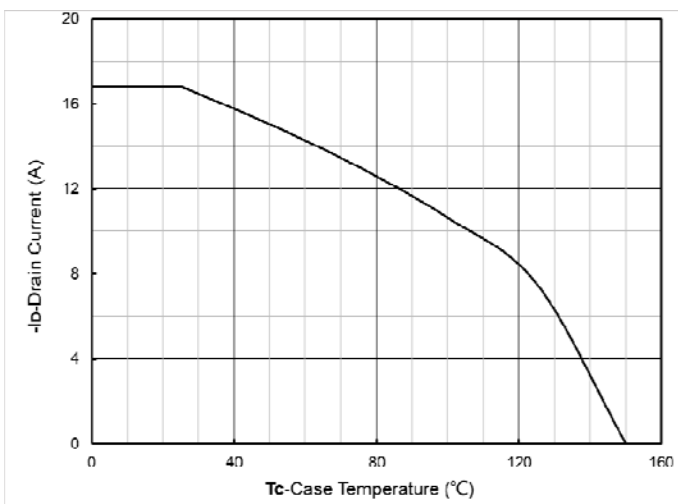

Figure 11. Current dissipation

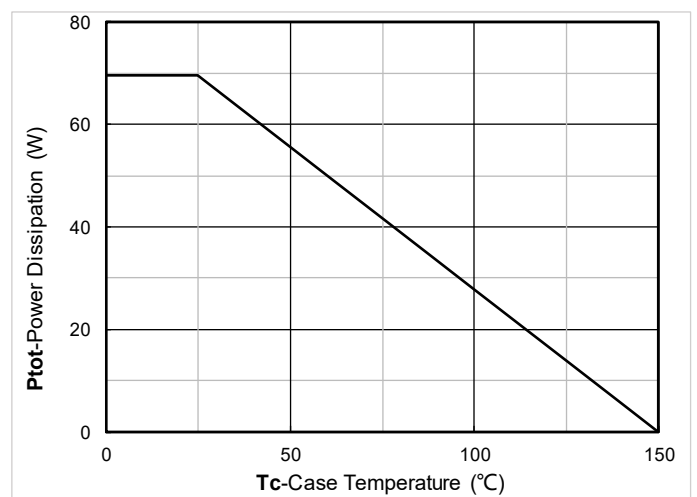

Figure 12. Power dissipation



YJG122GP10HHQ

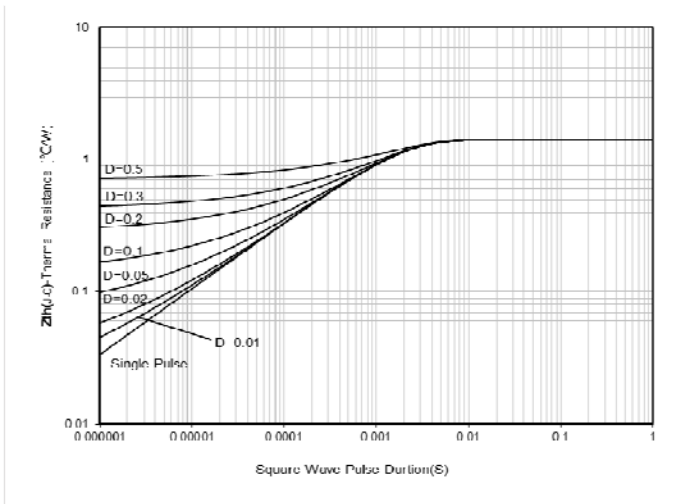

Figure 13. Maximum Transient Thermal Impedance

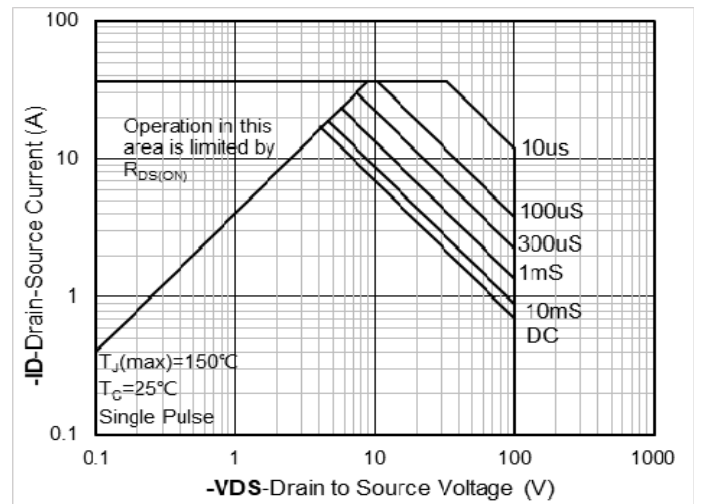
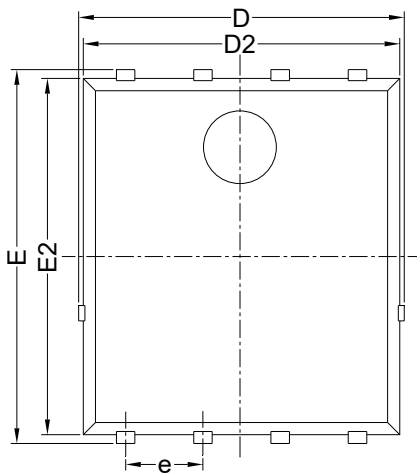

Figure 14. Safe Operation Area



YJG122GP10HHQ

Package information



Top View
正面视图

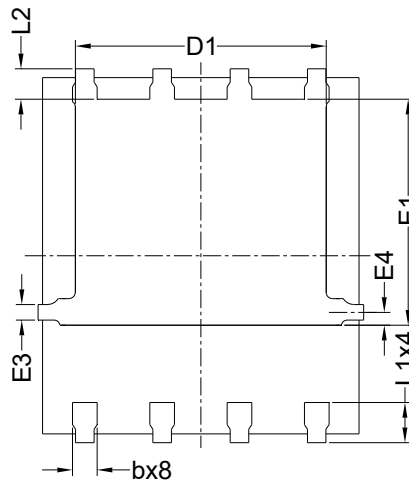

Bottom View
背面视图

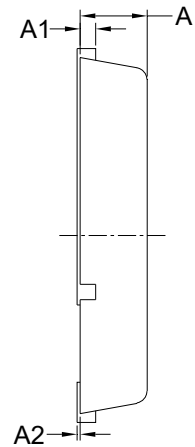

Side View
侧面视图

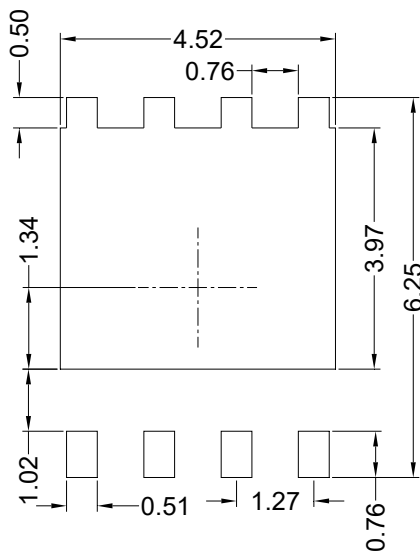

Suggested Solder Pad Layout
Top View

| SYMBOL | MILLIMETER | | |
|--------|------------|------|------|
| | MIN | NOM | MAX |
| D | 5.15 | 5.35 | 5.55 |
| E | 5.95 | 6.15 | 6.35 |
| A | 1.00 | 1.10 | 1.20 |
| A1 | 0.254 BSC | | |
| A2 | | | 0.10 |
| D1 | 3.92 | 4.12 | 4.32 |
| E1 | 3.52 | 3.72 | 3.92 |
| D2 | 5.00 | 5.20 | 5.40 |
| E2 | 5.66 | 5.86 | 6.06 |
| E3 | 0.254 REF | | |
| E4 | 0.21 REF | | |
| L1 | 0.56 | 0.66 | 0.76 |
| L2 | 0.50 BSC | | |
| b | 0.31 | 0.41 | 0.51 |
| e | 1.27 BSC | | |

Note:

1. Controlling dimension: in millimeters.
2. General tolerance: ± 0.10 mm.
3. The pad layout is for reference purposes only.

Marking Information





YJG122GP10HHQ

Disclaimer

The information presented in this document is for reference only. Yangzhou Yangjie Electronic Technology Co., Ltd. reserves the right to make changes without notice for the specification of the products displayed herein to improve reliability, function or design or otherwise.

The product listed herein is designed to be used with automotive electronics, are not designed for use in medical, life-saving, lifesustaining, or military, Yangjie or anyone on its behalf, assumes no responsibility or liability for any damages resulting from such improper use of sale.

This publication supersedes & replaces all information previously supplied. For additional information, please visit our website <http://www.21yangjie.com>, or consult your nearest Yangjie's sales office for further assistance.